



Things to do in and around Portarlington

✂ Bellarine Taste Trail

Pick up a map from Reception and discover the local delicacies and farm produce of the Bellarine Peninsula directly from the farm gate. Enjoy wine tasting and a bite to eat at one of the many local wineries including Jack Rabbit Vineyard, Bellarine Estate Winery And Brewery or Terindah Estate. Take the kids blueberry picking at Tuckerberry Hill Berry Farm, indulge in some fresh milk or hand-made goats cheese and yoghurt at Drysdale Cheeses, or try the smoked goodies available at Bellarine Smokehouse, mmm yum! Don't forget to pick up some locally-grown mussels from the various traders in Portarlington, Bellarine or St Leonards, and how about a drizzle of olive oil with that from Lighthouse Olive Mill Shop or Manzanillo Olive Grove, both located in Drysdale?

✂ Portarlington Mussel Festival

The Portarlington Mussel Festival continues to be proudly sponsored by Bellarine Bayside. The Festival is held from 9:30 AM to 5:00 PM on the second Saturday in January every year in the picturesque village of Portarlington on the Bellarine Peninsula in Victoria. Since its inception in 2007, the festival has grown year on year and now attracts around 30,000 people. Initially established to promote the Portarlington Mussel Industry, the festival now boasts a full day of activities including, live entertainment, kids activities, cooking demonstrations, art & photo exhibitions, classic car displays, food & wine products, plus plenty of mussels!!! For more information visit their website: www.portmusselfestival.com

✂ National Celtic Festival

The National Celtic Festival is held in Portarlington on the June long weekend every year. Running over the entire three days the festival attracts music-lovers from Australia and all round the world. The event embraces all aspects of the Celtic culture and is a wonderful showcase of bagpipes, bodhrans and wonderful craic sponsored by Bellarine Bayside. More information is available at www.nationalcelticfestival.com

✂ Northern Bellarine Coastal Trail

Get up close and personal with nature on The Northern Bellarine Coastal Trail which spans the foreshore from Point Richards to St Leonards. Walk, run or cycle along its meandering path taking you along the beach and sand dunes, across creeks and around the salt marsh. Stop for a breather on one of many furniture pieces installed on the trail, take in an amazing sunset stretching across the Bay, or simply appreciate your surroundings with some bird watching.

✂ Fishing / Boating / Watersports

The Bellarine Peninsula is the ideal location to base yourself if the ocean calls your name. Launch your boat or jet ski from one of six boat ramps situated on our foreshore. One of these is located within the Portarlington Holiday Park for the exclusive use of holiday makers staying in the Park. With Bay access right at your doorstep why not try stand-up paddleboarding (SUP), snorkel the Ozone wreck at Indented Head, drop in a line or two from the Pier or just chill out and laze on the beach watching others at play in the Bay. Remember if you are over 18 and plan to fish in the Bay you will need to have a valid Fishing Licence. These are available online from agriculture.vic.gov.au/fisheries, or in person at the Portarlington Post Office in Newcombe St or the General Store in Indented Head. Boat hire is also available in Indented Head from Beachlea Boat Hire, phone 0403 890 565.

✂ For the Kids

Apart from fishing and swimming in the beautiful Bay, there are activities aplenty all over the Bellarine Peninsula for the kids to enjoy! Have a day out on the water slides at Adventure Park in Wallington (closed throughout winter). Check out the Marine & Freshwater Discovery Centre at Queenscliff. Unexpected summer rain or visiting us during winter? Have a coffee and bite to eat while the kids play indoors at Picnic Time in Drysdale. What plants and animals can you find in the Flora & Fauna Reserve at Point Richards? Take a walk or ride your bike on our coastal trails that connect Point Richards in Portarlington through to Edwards Point in St Leonards.

Holiday Park Rules

1. A maximum of six (6) occupants, including children, may stay overnight at any site at any one time.
2. Offensive behaviour and excessive noise is forbidden. This includes but is not limited to violence, bad language, drug use, drunken behaviour, underage drinking, stealing, abuse, excessive noise and noise emanating from your site after 11pm that in the opinion of a park officer is audible at any other site.
3. Bicycles are permitted to be ridden during daylight hours only. An approved helmet is to be worn at all times and road rules and speed limits adhered to. Skateboards and motorized recreational scooters are prohibited.
4. Children under the age of seven (7) years, must be accompanied by an adult when using the amenities blocks.
5. The use of solid fuel barbecues and open fires is not permitted at any time. Gas barbecues are allowed.
6. Domestic animals are not permitted in any Bellarine Bayside Holiday Park.
7. A camping site may contain one caravan and annexe, or provided there is no annexe, one caravan (including awning) and two tents, or no more than three tents. Please seek permission for use and placement of a swag. (Please refer to Site Set-up rules for placement of van/annexe).
8. Clotheslines, rope or any other form of hanging device is not to be erected between trees, caravans or any other site structure.
9. The speed limit is 10km per hour. An officer of the park has authorisation to evict any vehicle from the park if exceeding this limit.
10. Visitors to sites are prohibited from parking within the Park grounds. Every Visitor remaining on site between the hours of 10pm and 8am must be registered at reception and overnight fees will apply.

Please see website for full list of Holiday Park Rules.

Guide to Site Set-up

Rebooking procedure

If you have stayed 7 nights or more and wish to rebook the same site or cabin for the following year you are required to book and lodge the applicable holding deposit of \$150 prior to your departure. NO EXCEPTIONS! New bookings or changes to your existing booking can be made after the season closes (i.e. the last week in April).

Cancellations

All cancellation requests must be given **in writing** and will incur an administration fee. Cancellation notices received up to 7 days prior to arrival will incur a \$30 administration fee. Cancellation notices received 6 to 2 days prior to arrival will incur a \$50 administration fee. Refunds will not apply for cancellations made 2 or less days prior to your arrival date, or for cancellation notices received after the scheduled arrival date.

Disclaimer: Trees in this park are inspected regularly by qualified arborists, however, branches are still prone to fall from time to time. No responsibility will be accepted for personal or property damage caused by falling trees or branches.

Is your power lead Safe to use?

Bellarine Bayside has, as part of Occupational, Health and Safety requirements, taken on the task to ensure all campers' leads are compliant with current safety standards. As a service to our campers, leads will be tested and tagged FREE OF CHARGE by our rangers. If your lead fails in the testing, Bellarine Bayside has 15 m leads available for purchase at a cost of \$30.00 per lead. To ensure your lead complies with safety standards it must be 15 amp, be tagged and tested and be long enough to reach your campsite in one length (approx. 15 metres).

Family and disabled bathrooms

Keys are available at reception. A \$20 refundable key deposit is required. Please return key to Reception prior to departure to receive your refund.

TENTS / CAMPER TRAILERS

An allowance for unobstructed fire access of approx. 1.2m is requested on each site

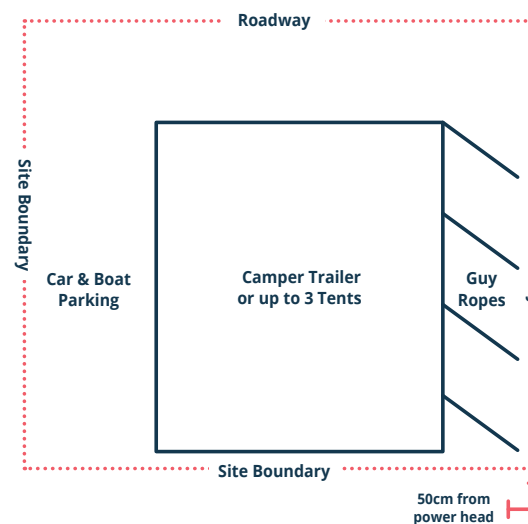

CARAVANS

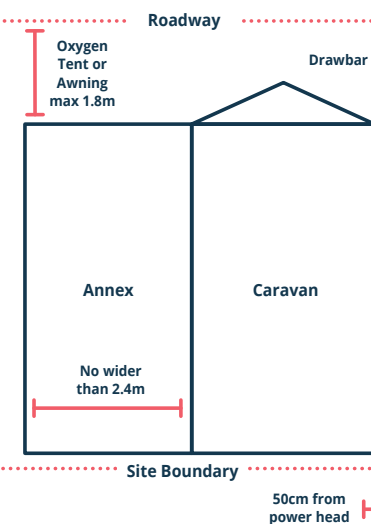

Sites not set up in accordance with these minimum CFA distance and access requirements will be asked to conform

- All structures should be set up on the left of the site boundary as you approach the site from roadway.
- ONE Gazebo **not exceeding 16 square metres**, is permitted per site.

Bellarine Bayside Holiday Parks



Portarlington



info@bellarinebayside.com.au • www.bellarinebayside.com.au
1800 222 778 • PO Box 40, Portarlington VIC 3223



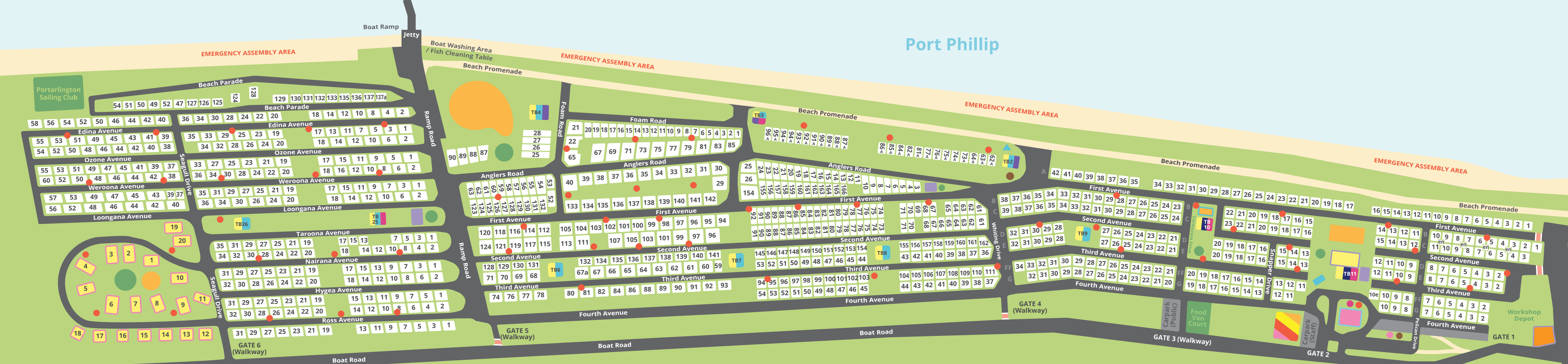

Map Key

- | | | |
|----------------|-----------------|--|
| Admin Office | Fire Hydrant | Outdoor Shower |
| Reception | Ensuite | Toilet Block |
| Arthurs Lounge | BBQ | Toilet Block / Laundry |
| Campsite | Camp Kitchen | Toilet Block / Laundry / Disabled Bathroom |
| Cabin | Bike Hire | Toilet Block / Family Bathroom / Disabled Bathroom |
| Playground | Carpark (Staff) | Toilet Block / Laundry / Baby Bath |
| Jumping Pillow | Games Room | Toilet Block / Laundry / Baby Bath / Disabled Bathroom |
| Gas Bottles | Laundry | Emergency Exit |
| Dump Point | | |

EMERGENCY EVACUATION PROCEDURES

When officially advised that an EMERGENCY exists you should:

- Secure your valuables
- Turn off power and gas to your site
- Close all windows, doors and hatches
- Gather your family
- Walk to the nearest assembly area which is, at **Portarlington** *On the beach or *Football Oval
- Wait for instructions from Emergency Services

DO NOT attempt to move your car or caravan. This will only block the road and restrict access by emergency crews.

IN A LIFE THREATENING EMERGENCY

DIAL 000

For Fire, Police and Ambulance anytime day or night.
For Bellarine Bayside 24 hour service and to notify park management or security staff **Ph: 5254 4011**

Cabin Accommodation

DELUXE CABIN

Accommodates up to 6 people

Queen size bed • All linen provided • Larger living area than other cabins • Reverse cycle air-conditioning • Ensuite • Separate toilet • Fully equipped kitchenette (inc. microwave & fridge) • TV in both main bedroom and living area • DVD player • Hair dryer • Iron and ironing board • Covered deck with outdoor setting • Parking available for car and boat • Cabins 3 and 11 through 20 (*Cabin 3 has a larger living area*)

PARK CABIN

Accommodates up to 5 or 6 people

Double bed • All linen provided • reverse cycle air conditioning • Ensuite • Fully equipped kitchenette (inc. microwave and fridge) • TV and DVD player in living area • Iron and ironing board • Decking with outdoor setting • Parking available for car and boat • 2x double beds in Cabins 5 and 10 only • Cabins 5 through 10

STANDARD CABIN

Accommodates up to 5 people

All linen provided • Reverse cycle air conditioning • Ensuite • Fully equipped kitchenette (inc. microwave and bar fridge) • Television and DVD player • Iron and ironing board • Bunk beds suitable for children only* • Small decking area • Parking available for car and boat • Cabins 1, 2 & 4 *Please Note: Children under 9 years old should not use top bunks

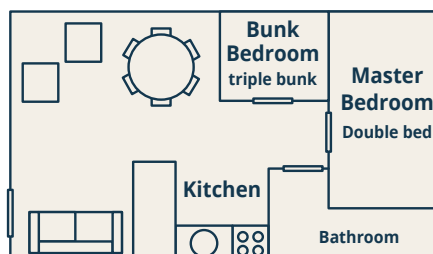
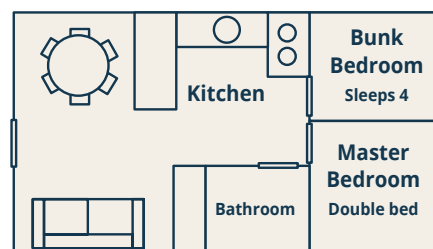
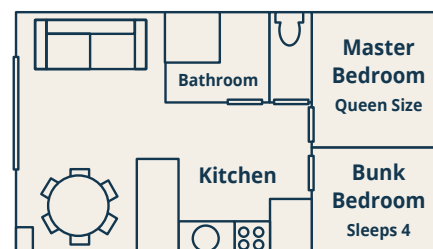

Bellarine Peninsula Map

